

# WALKER CENTER RETAIL

175 South Main Street  
Salt Lake City, Utah

Premiere CBD  
Retail Space Available

#### property information

- 110,000 SF Landmark Historic Class A office building located in the heart of Salt Lake's financial district. Building systems upgraded in 2005 to Class A standards.
- 2,206 RSF of street level retail space available with exceptional Main Street visibility.
- Prominent signage available for retail tenant.
- Over 3 million tourists visit downtown annually.
- Nearly 2 million square feet of office space within a ½ block with nearly 10,000 office workers at the intersection.
- For merchandise delivery there is convenient semi-trailer parking on 2nd South at Main.
- Gallivan Center, downtown Salt Lake's town square, hosts over 300 events per year and just underwent a \$6 million renovation. Gallivan Center is located directly across the street from Walker Center.
- Within 1 block of 2 TRAX stations, with 4 new lines coming in the next two years.
- Within 1 block of City Creek Center



RETAIL SPACE FOR LEASE



marketed by:

Chris Kirk **801.303.5495**  
ckirk@comre.com

Thomas Kirk, CCIM **801.303.5432**  
tkirk@comre.com

Todd McLachlan **801.303.5508**  
tmclachlan@comre.com

Justin Bailey **801.303.5493**  
jbailey@comre.com



170 South Main Street, Suite 1600 • Salt Lake City, Utah 84101  
Tel 801-322-2000 Fax 801-322-2040 • www.comre.com

# WALKER CENTER RETAIL

## City Creek Center

- \$1.5 billion project completed in 2012
- Approximately 825,000 SF of shopping and dining, anchored by Nordstrom and Macy's
- 1.4 million square feet of office space
- 542 residential units

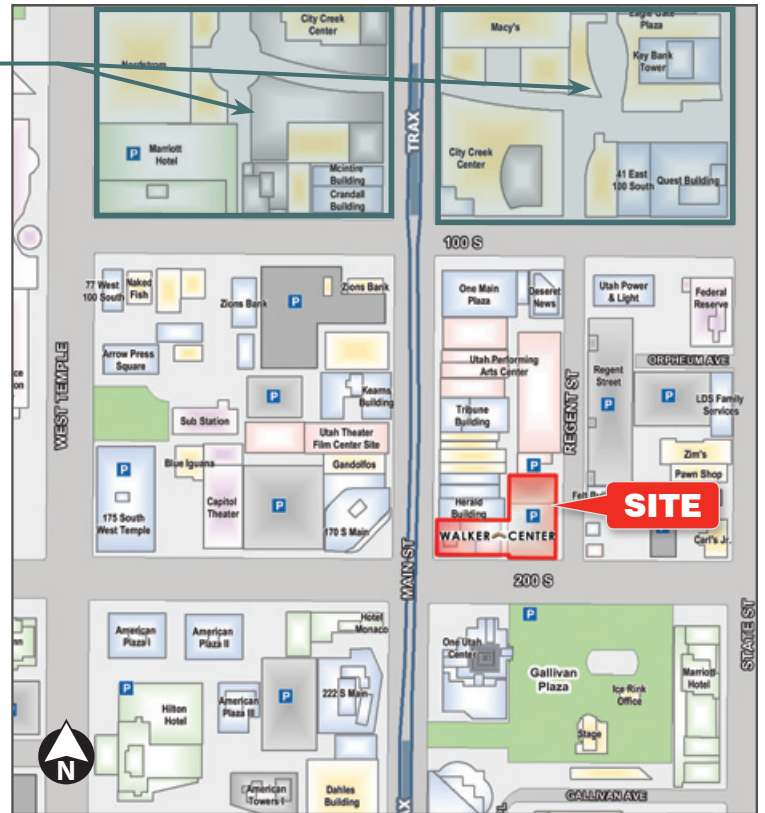

DEMOGRAPHICS	1 Mile	3 Mile	5 Mile
<b>POPULATION</b>			
2010 Estimated Population	19,990	135,861	222,896
2015 Projected Population	21,426	142,876	234,056
<b>HOUSEHOLDS</b>			
2010 Estimated Households	10,875	54,370	86,669
2015 Projected Households	11,773	57,390	91,346
2010 Est. Median HH Income	\$48,388	\$59,025	\$62,995
2010 Est. Per Capita Income	\$33,820	\$44,556	\$48,811
2010 Est. Average HH Income	\$27,415	\$24,244	\$25,102

Source: U.S. Bureau of the Census, 2000 Census of Population and Housing.  
Esri forecasts for 2010 and 2015. Esri converted 1990 Census data into 2000 geography.

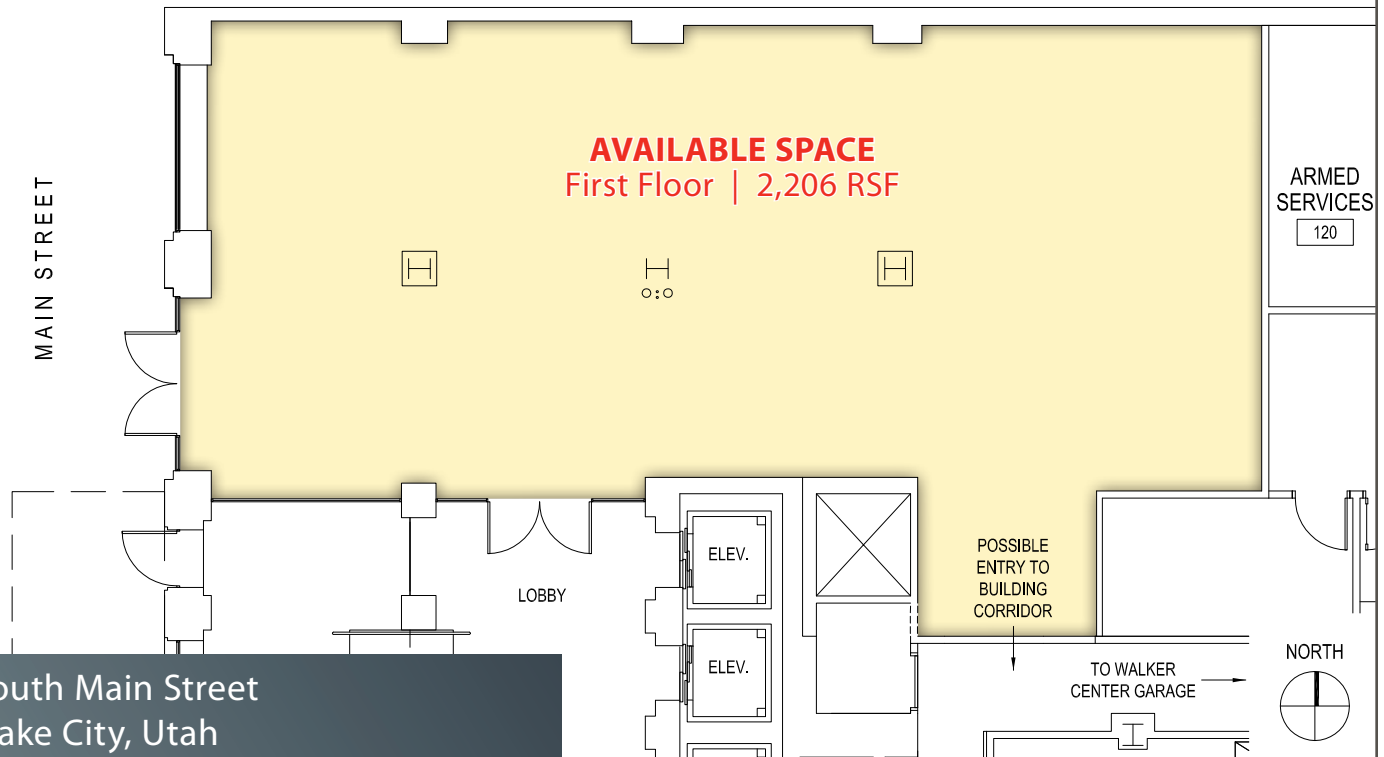

175 South Main Street  
Salt Lake City, Utah

marketed by:

Chris Kirk 801.303.5495  
ckirk@comre.com

Thomas Kirk, CCIM 801.303.5432  
tkirk@comre.com

Todd McLachlan 801.303.5508  
tmlachlan@comre.com

Justin Bailey 801.303.5493  
jbailey@comre.com



**CUSHMAN & WAKEFIELD**

**COMMERCE**  
REAL ESTATE SOLUTIONS • COMRE.COM

INDEPENDENTLY OWNED AND OPERATED

170 South Main Street, Suite 1600 • Salt Lake City, Utah 84101  
Tel 801-322-2000 Fax 801-322-2040 • www.comre.com

©2012, Commerce Real Estate Solutions. Disclaimer: The above information is given with the obligation that all negotiations relating to the purchase, renting, or leasing of the property described above shall be conducted through Commerce Real Estate Solutions. No warranty or representation, express or implied, is made as to the accuracy of the information contained herein, and same is submitted subject to errors, omissions, change of price, rental or other encumbrances, withdrawal without notice, and to any special listing conditions imposed by the seller. Prospective buyers should conduct their own due diligence. Some aerial photography by DigitalGlobe or Aerials Express.  
path:K\1 - Projects\Kirk, CV1 - Flyers\WalkerCenter\Walker Center Retail Brochure